

Direita

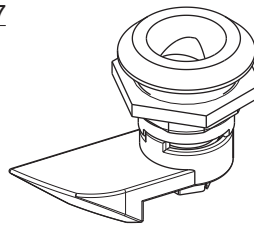

Esquerda

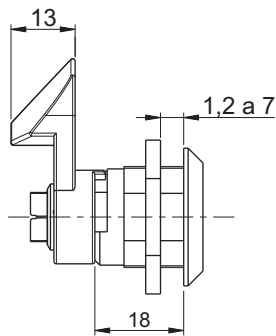
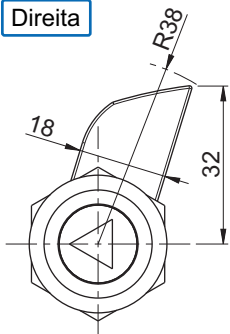
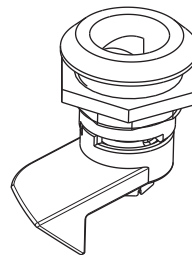
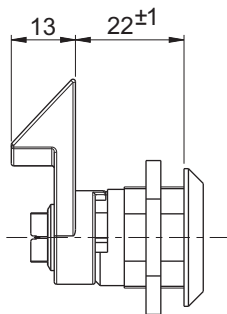
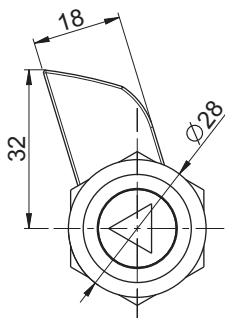

Furação para montagem

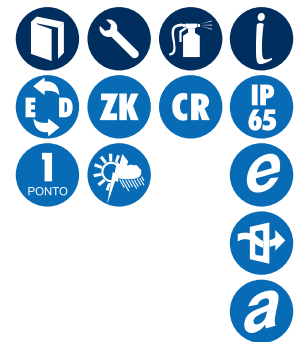
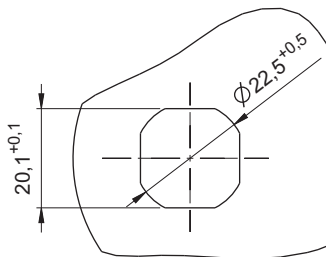

DADOS TÉCNICOS

Fornecimento:

Bucha, miolo, porca e lingueta injetados em zamak.

Acabamento:

Cromado. Porca zincada trivalente branco.





Montagem:

Fácil instalação, sem necessidade de desmontagem da lingueta. Fixação através de porca. Fechamento e travamento sem utilização de chave.

Acessórios:

Chapas estampadas (Pág. 52). Chaves (Pág. 55, 56, 57, 58 e 59).

CROMADO

ABERTURA	 MIOLO TRIÂNGULO	 MIOLO QUADRADO	 MIOLO UNIVERSAL	 MIOLO CASTELO	 MIOLO FENDA
Direita	23106	23116	23136	23146	23126
Esquerda	23105	23115	23135	23145	23125